

Vibrating Feeder with Magnetic Drum

03.03.01

Model "OCH+MDB"

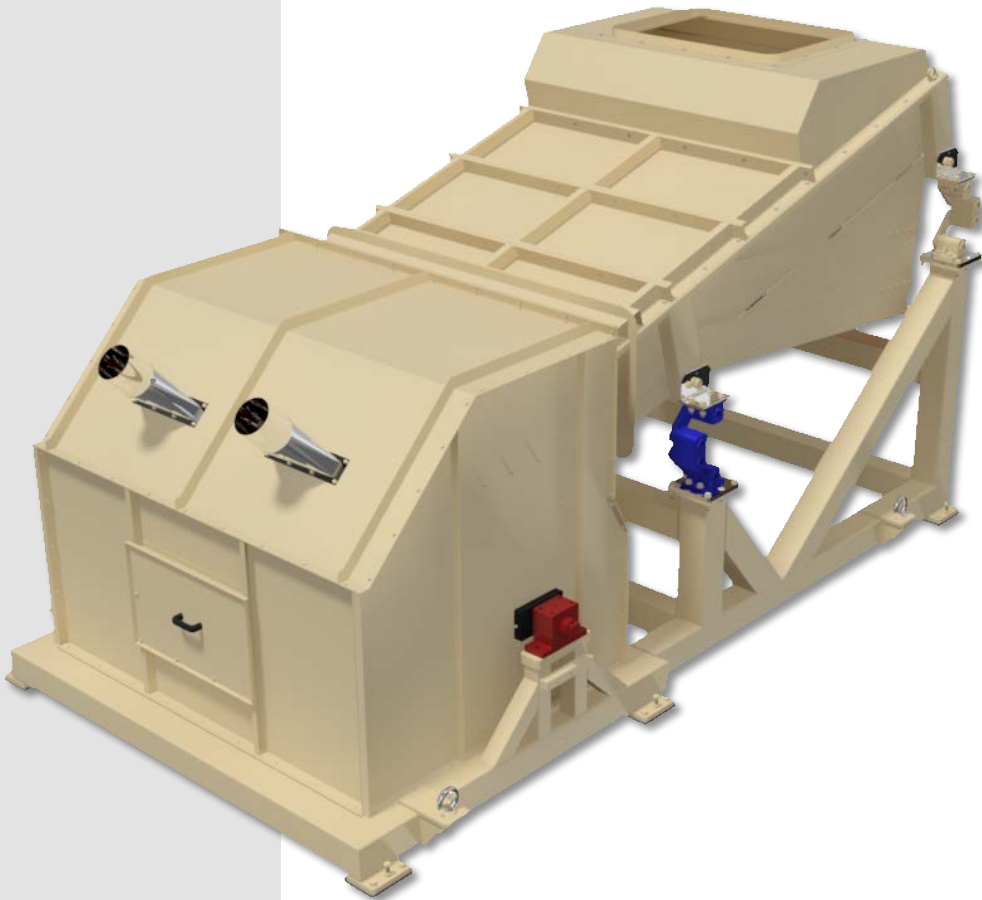

BEST TO



PANELS WOOD-BASED

- MDF/HDF
- PB
- OSB



WASTE TREATMENT

- Waste and scrap processing



ENERGY

- Biomass wood-based
- Wood pellets

TECHNICAL CHARACTERISTICS

- BULLMECH "OCH+MDB" vibrating feeders with magnetic drum are designed to guarantee maximum distribution efficiency with minimum energy consumption.
- Unlike the normal vibrating feeders on the market that use metal springs for the suspension of the channel, BULLMECH uses ROSTA® elastic elements that guarantee high distribution efficiency without transmitting dangerous vibrations to the support structures.
- The presence of powerful magnetic drums at the exhaust (available in three variants) ensures maximum efficiency in the removal of ferrous pollutants from chips, sawdust, wood particles and all those products that require this type of cleaning.
- Special side seals associated with integrated cleaning and suction systems, guarantee the absence of external dust and allow the installation of the machines even in dusty and potentially explosive areas, as required by the ATEX regulation.

BENEFITS

- Excellent separation of ferrous materials and distribution of materials.
- Low energy costs.
- Very low maintenance costs.
- Maximum cleaning of the system.
- Leaner and less expensive support structures.

Vibrating Feeder with Magnetic Drum



Model "OCH+MDB"

DATA SHEET

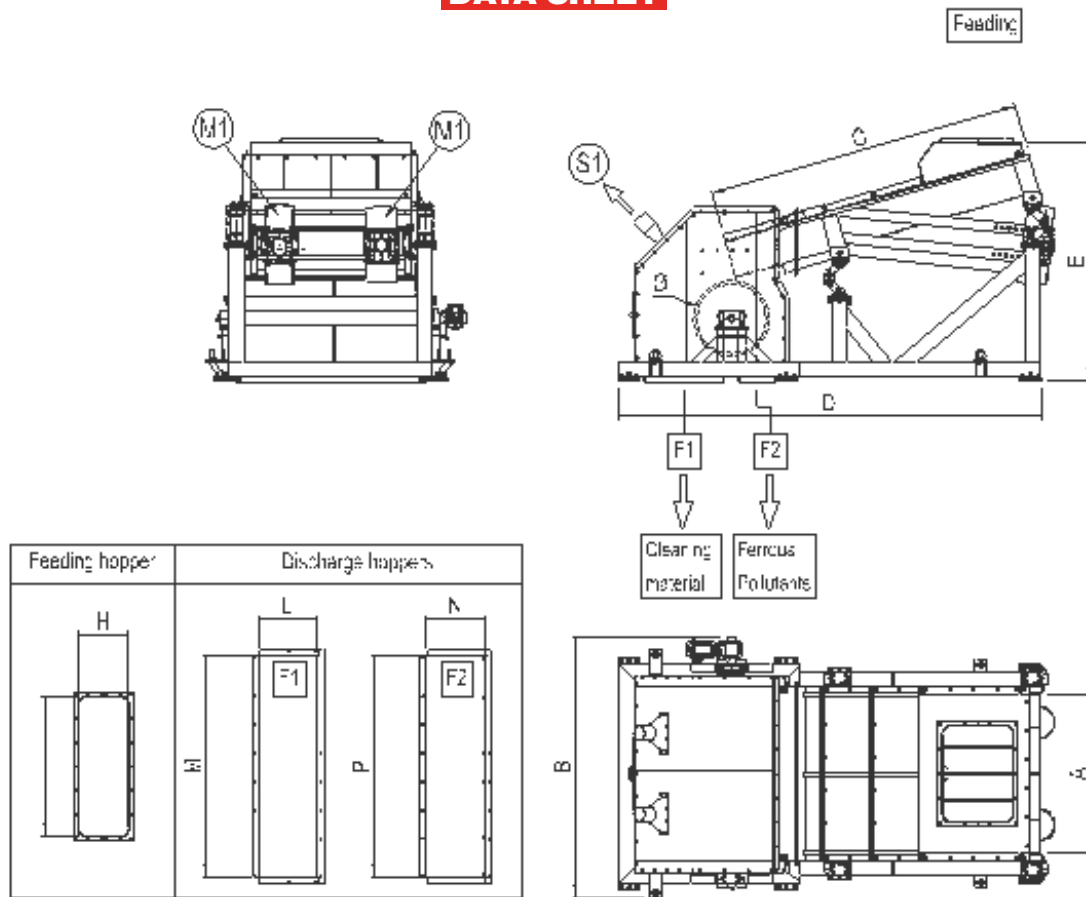

MODEL	OVERALL DIMENSIONS [mm]									Capacity	Installed power	Working moment at 50Hz	Working moment at 60Hz	Air suction [only for Dry material]	Weight approx.
	A	B	C	D	E	H x I	L x M	N x P	Ø	[m³/h]	M1 [kW]	[kgcm]	[kgcm]	S1	[kg]
OCH 060/18 + MDB-320x700	600	1.430	1.800	2.720	1.650	400x400	500x890	300x890	320	See detailed model sheet	See detailed model sheet	See detailed model sheet	See detailed model sheet	See detailed model sheet	See detailed model sheet
OCH 090/20 + MDB-400x1000	900	1.730	2.000	2.920	1.750	500x600	595x1.190	300x1.190	400						
OCH 090/25 + MDB-400x1000	900	1.730	2.500	3.520	1.950	500x600	595x1.190	300x1.190	400						
OCH 140/25 + MDB-600x1500	1.400	2.330	2.500	3.620	1.950	500x900	755x1.690	300x1.690	600						
OCH 150/30 + MDB-700x1600	1.500	2.430	3.000	4.220	2.150	500x1.000	795x1.790	355x1.790	700						
OCH 160/30 + MDB-700x1700	1.600	2.530	3.000	4.220	2.150	500x1.000	795x1.890	355x1.890	700						
OCH 180/30 + MDB-700x2000	1.800	2.730	3.000	4.220	2.150	500x1.200	795x2.190	355x2.190	700						
OCH 200/30 + MDB-800x2200	2.000	2.900	3.000	4.320	2.250	500x1.400	895x2.390	455x2.390	800						

Vibrating Feeder with Magnetic Drum



Model "OCH+MDB"

CODE DEFINITION

TYPE Vibrating plane			Vibrating plane length			/		Vibrating plane width		-		Extra load capacity		+			TYPE Drum diameter			-			Drum diameter			x			Drum length			/			Type of magnet [a]		-				Equipment compliant with 2014/34/EU ATEX [b]			
O	C	H	1	6	0	/	3	0	-	X	L	+	M	D	B	-	7	0	0	x	1	7	0	0	/		H	G	-	A	T	2	2											

[a]: HG = Magnetic attraction standard.

VHG = Magnetic attraction high.

UHG = Magnetic attraction ultrahigh.

[b]: AT22 = Area classified ATEX zone 22.

= Unclassified area (omit).

TYPE	Vibrating plane length	Vibrating plane width	Capacity	Installed power	Working moment at 50Hz	Working moment at 60Hz	Air suction [only for Dry material]	Weight approx.
	[mt]	[mt]	[m ³ /h]	[kW]	[kgcm]	[kgcm]	[m ³ /h]	[kg]
OCH 060/18 + MDB-320x700	1,8	0,6	40,0	2,2	184	128	1 x 800	1.300
OCH 060/18-XL + MDB-400x700			60,0	3,6	375	275	1 x 800	1.500
OCH 090/20 + MDB-400x1000	2,0	0,9	65,0	3,6	375	275	2 x 800	1.800
OCH 090/20-XL + MDB-500x1000			95,0	4,1	802	550	2 x 800	2.100
OCH 090/25 + MDB-400x1000	2,5	0,9	80,0	3,0	375	275	2 x 800	2.300
OCH 090/25-XL + MDB-700x1000			105,0	3,3	600	406	2 x 800	2.500
OCH 140/25 + MDB-600x1500	2,5	1,4	110,0	4,5	802	550	2 x 1.000	2.700
OCH 140/25-XL + MDB-600x1500			150,0	5,9	1.080	760	2 x 1.000	3.200
OCH 150/30 + MDB-700x1600	3,0	1,5	125,0	4,5	802	550	2 x 1.000	3.600
OCH 150/30-XL + MDB-700x1600			175,0	5,9	1.405	930	2 x 1.000	4.000
OCH 160/30 + MDB-700x1700	3,0	1,6	140,0	5,9	1.405	930	2 x 1.200	4.000
OCH 160/30-XL + MDB-700x1700			190,0	7,9	1.676	1.168	2 x 1.200	4.800
OCH 180/30 + MDB-700x2000	3,0	1,8	160,0	5,9	1.405	930	3 x 1.000	5.000
OCH 180/30-XL + MDB-700x2000			270,0	8,6	1.676	1.168	3 x 1.000	5.500
OCH 200/30 + MDB-800x2200	3,0	2,0	180,0	7,9	1.676	1.168	3 x 1.200	5.500
OCH 200/30-XL + MDB-800x2200			300,0	10,8	2.330	1.648	3 x 1.200	6.300

Example for order: **OCH160/30-XL+MDB-700x1700/HG-AT22**