

Vibrating Feeder with Magnetic Drum

03.03.01

Model "OCH+MDB"

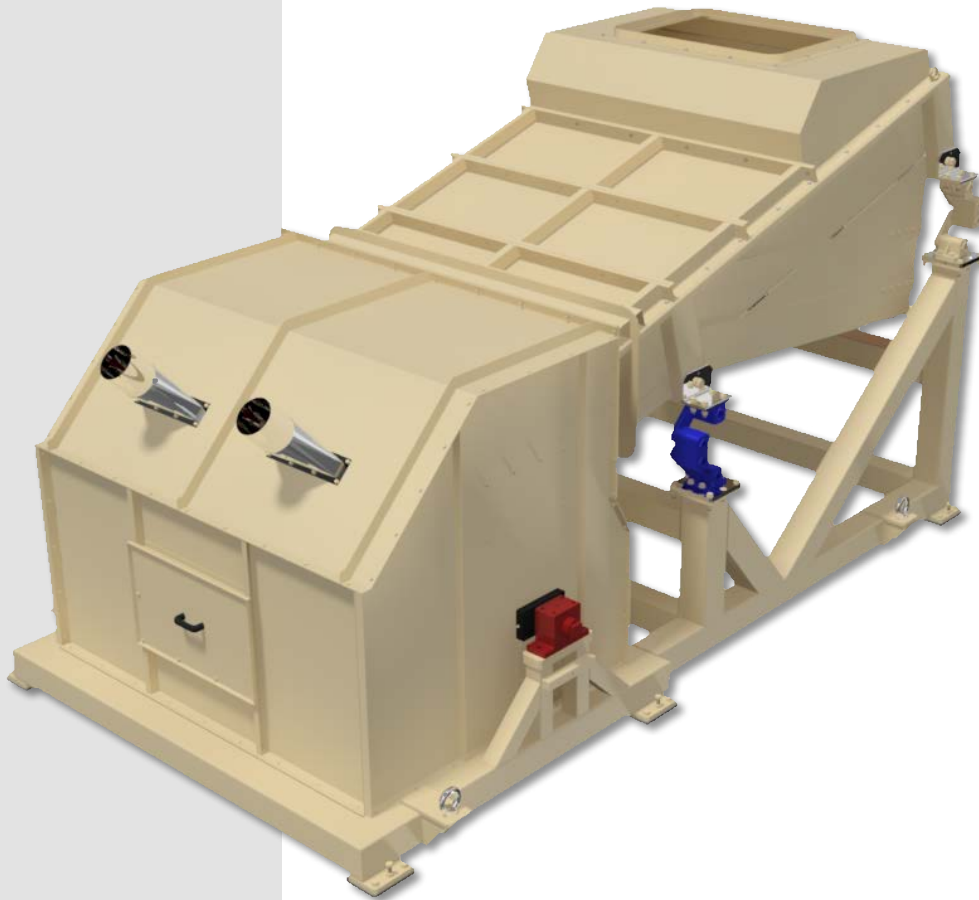

BEST TO



PANELS WOOD-BASED

- MDF/HDF
- PB
- OSB



WASTE TREATMENT

- Waste and scrap processing



ENERGY

- Biomass wood-based
- Wood pellets

TECHNICAL CHARACTERISTICS

- BULLMECH "OCH+MDB" vibrating feeders with magnetic drum are designed to guarantee maximum distribution efficiency with minimum energy consumption.
- Unlike the normal vibrating feeders on the market that use metal springs for the suspension of the channel, BULLMECH uses ROSTA® elastic elements that guarantee high distribution efficiency without transmitting dangerous vibrations to the support structures.
- The presence of powerful magnetic drums at the exhaust (available in three variants) ensures maximum efficiency in the removal of ferrous pollutants from chips, sawdust, wood particles and all those products that require this type of cleaning.
- Special side seals associated with integrated cleaning and suction systems, guarantee the absence of external dust and allow the installation of the machines even in dusty and potentially explosive areas, as required by the ATEX regulation.

BENEFITS

- Excellent separation of ferrous materials and distribution of materials.
- Low energy costs.
- Very low maintenance costs.
- Maximum cleaning of the system.
- Leaner and less expensive support structures.

Vibrating Feeder with Magnetic Drum



Model "OCH+MDB"

DATA SHEET

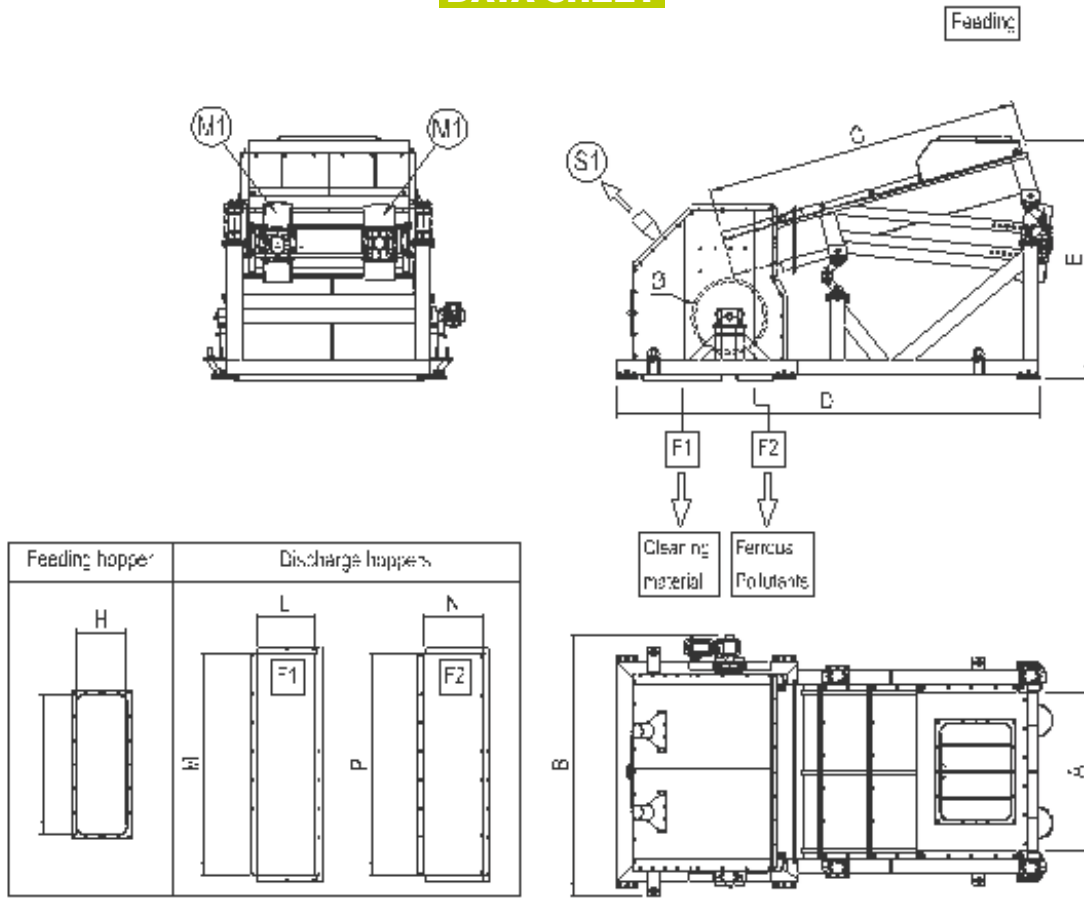

MODEL	OVERALL DIMENSIONS [mm]									Capacity [m ³ /h]	Installed power M1 [kW]	Working moment at 50Hz [kgcm]	Working moment at 60Hz [kgcm]	Air suction [only for Dry material] S1	Weight approx. [kg]
	A	B	C	D	E	H x I	L x M	N x P	Ø						
OCH 060/18 + MDB-320x700	600	1.430	1.800	2.720	1.650	400x400	500x890	300x890	320	40	2,2	184	128	1x800	500
OCH 060/18-XL + MDB-400x700		1.430	1.800	2.820	1.920	400x400	595x890	300x890	400	60	3,6	375	275	1x800	600
OCH 090/20 + MDB-400x1000	900	1.730	2.000	2.920	1.750	500x600	595x1.190	300x1.190	400	65	3,6	375	275	2x800	800
OCH 090/20-XL + MDB-500x1000		1.730	2.000	3.020	2.020	500x600	655x1.190	300x1.190	500	95	4,1	802	550	2x800	900
OCH 090/25 + MDB-400x1000	900	1.730	2.500	3.520	1.950	500x600	595x1.190	300x1.190	400	80	3,0	375	275	2x800	900
OCH 090/25-XL + MDB-700x1000		1.730	2.500	3.720	2.220	500x600	795x1.190	355x1.190	700	105	3,3	600	406	2x800	1.000
OCH 140/25 + MDB-600x1500	1.400	2.330	2.500	3.620	1.950	500x900	755x1.690	300x1.690	600	110	4,5	802	550	2x1.000	1.400
OCH 140/25-XL + MDB-600x1500		2.330	2.500	3.620	2.220	500 x900	755x1.690	300x1.690	600	150	5,9	1.080	760	2x1.000	1.600

Vibrating Feeder with Magnetic Drum



Model "OCH+MDB"

DATA SHEET

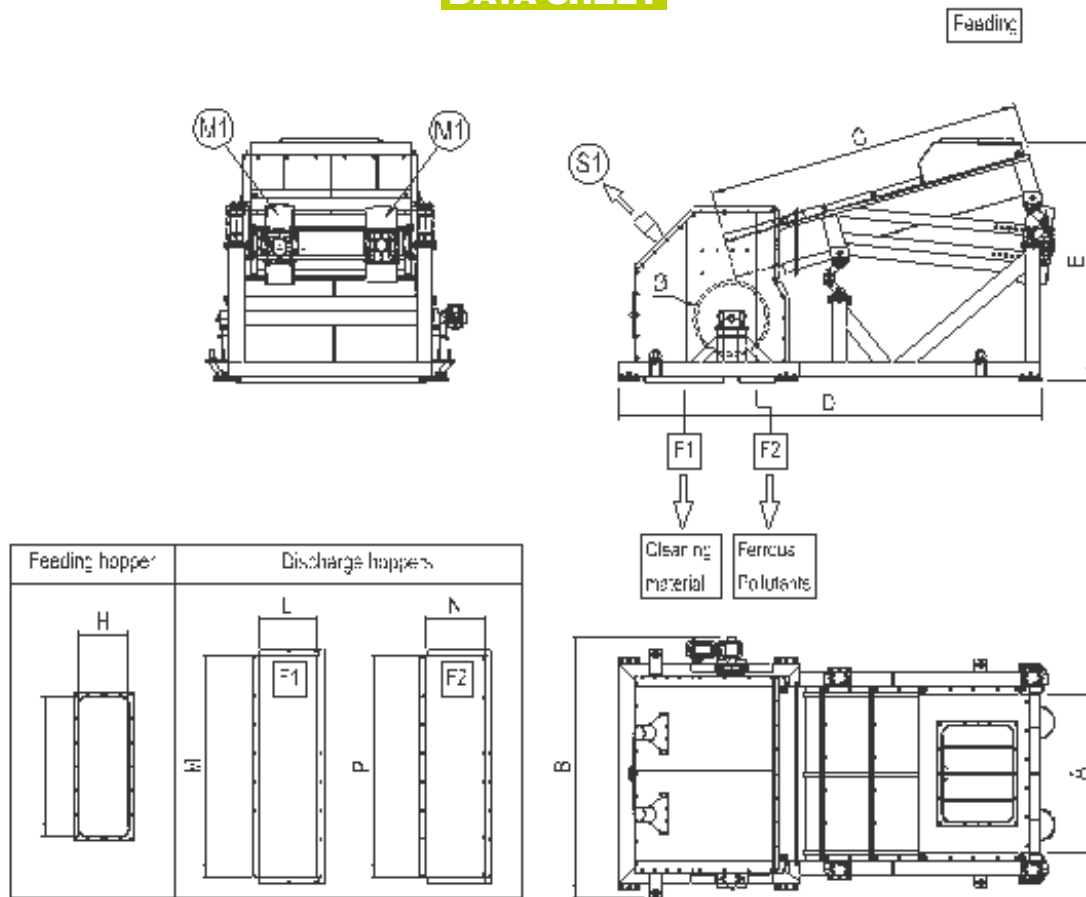

MODEL	OVERALL DIMENSIONS [mm]									Capacity [m ³ /h]	Installed power M1 [kW]	Working moment at 50Hz [kgcm]	Working moment at 60Hz [kgcm]	Air suction [only for Dry material] S1	Weight approx. [kg]
	A	B	C	D	E	H x I	L x M	N x P	Ø						
OCH 150/30 + MDB-700x1600	1.500	2.430	3.000	4.220	2.150	500x1.000	795x1.790	355x1.790	700	125	4,5	802	550	2x1.000	1.700
OCH 150/30-XL + MDB-700x1600		2.430	3.000	4.220	2.420	500x1.000	795x1.790	355x1.790	700	175	5,9	1.080	760	2x1.000	1.800
OCH 160/30 + MDB-700x1700	1.600	2.530	3.000	4.220	2.150	500x1.000	795x1.890	355x1.890	700	140	5,9	802	550	2x1.200	2.000
OCH 160/30-XL + MDB-700x1700		2.530	3.000	4.220	2.420	500x1.000	795x1.890	355x1.890	700	190	7,9	1.405	930	2x1.200	2.200
OCH 180/30 + MDB-700x2000	1.800	2.730	3.000	4.220	2.150	500x1.200	795x2.190	355x2.190	700	160	5,9	1.405	930	3x1.000	2.200
OCH 180/30-XL + MDB-700x2000		2.730	3.000	4.220	2.420	500x1.200	795x2.190	355x2.190	700	270	8,6	1.676	1.168	3x1.000	2.400
OCH 200/30 + MDB-800x2200	2.000	2.900	3.000	4.320	2.250	500x1.400	895x2.390	455x2.390	800	180	7,9	1.405	930	3x1.200	2.500
OCH 200/30-XL + MDB-800x2200		2.900	3.000	4.320	2.520	500x1.400	895x2.390	455x2.390	800	300	10,8	1.676	1.168	3x1.200	2.700

Vibrating Feeder with Magnetic Drum



Model "OCH+MDB"

CODE DEFINITION

TYPE Vibrating plane			Vibrating plane length			/	Vibrating plane width		-	Extra load capacity		+	TYPE Drum diameter			-	Drum diameter			x	Drum length			/	Type of magnet [a]		-	Equipment compliant with 2014/34/EU ATEX [b]					
O	C	H	1	6	0	/	3	0	-	X	L	+	M	D	B	-	7	0	0	x	1	7	0	0	/		H	G	-	A	T	2	2

[a]: HG = Magnetic attraction standard.

VHG = Magnetic attraction high.

UHG = Magnetic attraction ultrahigh.

[b]: AT22 = Area classified ATEX zone 22.

= Unclassified area (omit).

TYPE	Vibrating plane length	Vibrating plane width	Capacity	Installed power	Working moment at 50Hz	Working moment at 60Hz	Air suction [only for Dry material]	Weight approx.
	[mt]	[mt]	[m³/h]	[kW]	[kgcm]	[kgcm]	[m³/h]	[kg]
OCH 060/18 + MDB-320x700 OCH 060/18-XL + MDB-400x700	1,8	0,6	40,0	2,2	184	128	1 x 800	1.300
			60,0	3,6	375	275	1 x 800	1.500
OCH 090/20 + MDB-400x1000 OCH 090/20-XL + MDB-500x1000	2,0	0,9	65,0	3,6	375	275	2 x 800	1.800
			95,0	4,1	802	550	2 x 800	2.100
OCH 090/25 + MDB-400x1000 OCH 090/25-XL + MDB-700x1000	2,5	0,9	80,0	3,0	375	275	2 x 800	2.300
			105,0	3,3	600	406	2 x 800	2.500
OCH 140/25 + MDB-600x1500 OCH 140/25-XL + MDB-600x1500	2,5	1,4	110,0	4,5	802	550	2 x 1.000	2.700
			150,0	5,9	1.080	760	2 x 1.000	3.200
OCH 150/30 + MDB-700x1600 OCH 150/30-XL + MDB-700x1600	3,0	1,5	125,0	4,5	802	550	2 x 1.000	3.600
			175,0	5,9	1.405	930	2 x 1.000	4.000
OCH 160/30 + MDB-700x1700 OCH 160/30-XL + MDB-700x1700	3,0	1,6	140,0	5,9	1.405	930	2 x 1.200	4.000
			190,0	7,9	1.676	1.168	2 x 1.200	4.500
OCH 180/30 + MDB-700x2000 OCH 180/30-XL + MDB-700x2000	3,0	1,8	160,0	5,9	1.405	930	3 x 1.000	5.000
			270,0	8,6	1.676	1.168	3 x 1.000	5.500
OCH 200/30 + MDB-800x2200 OCH 200/30-XL + MDB-800x2200	3,0	2,0	180,0	7,9	1.676	1.168	3 x 1.200	5.500
			300,0	10,8	2.330	1.648	3 x 1.200	6.300

Example for order: **OCH160/30-XL+MDB-700x1700/HG-AT22**